

Revision: 1 Drawn: EB Checked: DF Approved: BP Date: 2024-04-17  
Filename: L:\Legacy\UKMCR\FF002-V1\Proposals\0512\Immingham GET GIS\02\_Maps\Change Application\ES figures\GET\_ES\_CA\_Ch23\_Fig23-1\_Socio\_Economic\_Receptors\_Site\_Boundary\_20240417\_EB.aprx

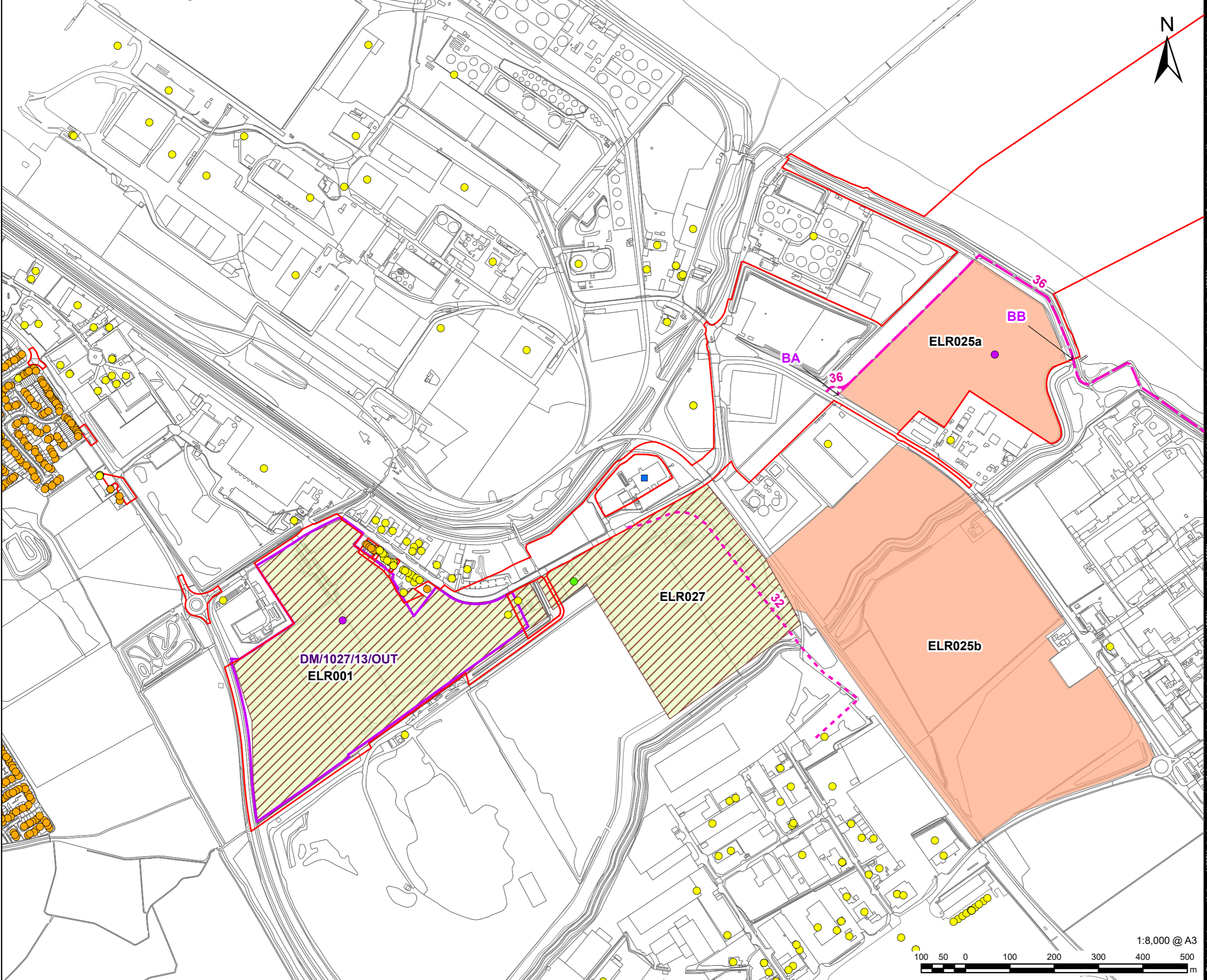

# AECOM

**PROJECT**  
Immingham Green Energy Terminal

**CLIENT**  
Associated British Ports  
Air Products (BR) Limited

**CONSULTANT**  
AECOM Limited  
5th Floor  
2 City Walk  
Leeds, LS11 9AR  
www.aecom.com

- LEGEND**
- Site Boundary
  - Private Assets
    - Residential Properties
    - Business Premises
    - Community Facilities
    - Agricultural Land
    - Border Control Post
  - Public Rights of Way
    - Public Footpath
    - Bridleway
    - Planning Permission
  - Employment Area
    - Employment - Proposed Allocation
    - Employment - Retained for Long Term Business Use
    - Enterprise Zone

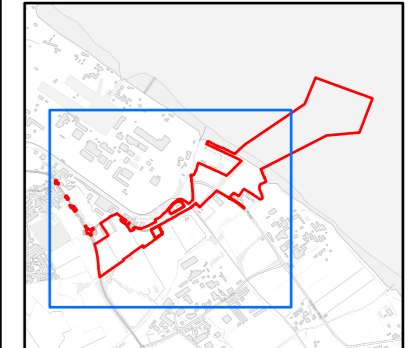

**NOTES**  
Reproduced from Ordnance Survey digital map data © Crown copyright 2024. All rights reserved. Licence number 0100031673.

**ISSUE PURPOSE**  
Environmental Statement (Change Application)

**PROJECT NUMBER**  
60673509

**DEVELOPMENT CONSENT ORDER NO**  
TR030008

**FIGURE TITLE**  
Socio-Economic Receptors within the Site Boundary

**FIGURE NUMBER**  
Figure 23.1